

**C: APPLICATION COVER SHEET FOR SUSPENDED CULTURE**

Name: Black Stone Point Oysters LLC  
 Address: 236 Bayview rd.  
 City: Nobleboro  
 County: Lincoln  
 State, zip: Maine, 04555  
 Telephone: business (207) 380 9888 home \_\_\_\_\_ cell \_\_\_\_\_  
 Email address: Brendan.R.Parsons@gmail.com  
 Date of Pre-application meeting: 10-5-17  
 Date of Scoping Session: 11-16-17

	<u>town</u>	<u>county</u>	<u>waterbody</u>
Location of lease site:	<u>Damariscotta</u>	<u>Lincoln</u>	<u>Damariscotta River</u>
Additional description (e.g. south of B Island)	<u>West, south, &amp; east of Hog Island</u>		
Total acreage requested: (100-acre maximum)	<u>12.98</u>	<u>Both Suspended</u>	<u>(gear on surface, in water column + bottom)</u>
Lease Term requested: (20-year maximum)	<u>20 years</u>		
Name of species to be cultivated, common and scientific names:			
<u>American Oyster (crassostrea virginica) European Oysters (ostrea edulis)</u>			
<u>Northern Quahog (mercenaria mercenaria)</u>			

Name, address and phone number of the source of seed stock, juveniles, smolts, etc., to be cultivated:

Mook Sea Farm, 321 ME-124 Walpole, ME 04573 (207) 563-1456  
Muscongus Bay Aquaculture, 24 Seal ledge Ln. Bremen, ME 04551 (207) 529-4100

\$1,500 application fee enclosed:

I hereby state that the information included in this application is true and correct and that I have read and understand the requirements of the Department's rules governing aquaculture.

Signature: [Signature] Date: 2-15-19  
 CEO/President: Brendan Parsons

18 U.S.C. Section 1001 provides that: Whoever, in any manner within the jurisdiction of any department or agency of the United States knowingly and willfully falsifies, conceals, or covers up any trick, scheme, or disguises a material fact or makes any false, fictitious or fraudulent statements or representations or makes or uses any false writing or document knowing same to contain any false, fictitious or fraudulent statements or entry, shall be fined not more than \$10,000 or imprisoned not more than five years or both.

MICROSOFT

# Black Stone Point Oysters LLC

---

Standard Lease Application – 12.98 Acres

2/15/2019

President/CEO – Brendan Parsons



2-15-19

## Application for Suspended Culture

### INTRODUCTORY

Black Stone Point Oysters LLC is proposing a 12.98 acre lease in the Damariscotta River using both suspended culture (gear on the surface, in the water column and on the bottom) and bottom culture (shellfish free-planted on the bottom with no gear) aquaculture techniques. The suspended culture site will be 2 acres and to the west of Hog Island and is highlighted in the plan view. The rest of the proposed lease will be bottom culture, where oysters will be harvested by diving, dragging, bull raking, and hand picking.

### 1. SITE LOCATION

- a. Vicinity Map
  - i. Attached
- b. Plan View
  - i. Attached
  - ii. All imagery and datum were derived from Google Earth Pro, the desktop version. Exact datum for corner markers are provided on pg. 8b
- c. No aerial photo taken within 12 months

### 2. SITE DEVELOPMENT

- a. Single Structure Schematic – Top View
  - i. Attached
- b. Single Structure Schematic - Cross section
  - i. Attached
- c. Maximum Structure and Mooring System schematic - Top View
  - i. Attached
  - ii. Long lines measure 300' or 100' mooring lines of 35' will be attached to 5' helix anchors that are described in further detail
- d. Maximum Structure and Mooring System Schematic – Cross Section
  - i. – Attached
- e. On- Site Support Structures
  - i. A shellfish raft approximately 30" above the water measuring 12x16ft will be placed on a pre-existing 2,000lb mooring and a helix anchor within the proposed lease site to the south of Hog Island (mooring is pictured on the plan view). This platform will be used for sorting and grading oysters and drying gear. It will also contain four 5x5x5 bins for wet storage. The floats on the raft are 4'x8'x20"





polyethylene floats that are rated for 2960lbs and there will be 4 of them in total. The dock itself will be built entirely out of hemlock. A framed structure 8'x12'x10' with a temporary roof for shelter will be erected on the raft. This structure will eventually be enclosed to provide greater protection against the elements for workers. In winter the raft will be stored in the cove on the north side of Hog Island.

- ii. No mechanical equipment will be used besides outboard motors on the work boats and a wash down pump. All gasoline will be kept on Hog Island and used accordingly.
- iii. Workers will be using a sanitary facility on Hog Island

**f. Mooring System Adequacy**

- i. Attached and explained in 'surface grow out summary'. Moorings for long lines will be Helix anchors every 100 feet along the line. Each helix anchor is 3/4" x 6" x 60" and has a 6,500# break force ([www.westechrigging.com](http://www.westechrigging.com)) No engineering analysis has been performed but larger helix anchors have been included to ensure the system's ability to withstand severe storms and surges

**g. Equipment Layout**

- i. Attached and explained in 'surface grow out summary'

**h. Gear Color**

- i. Cages will have custom orange tags made listing 'Black stone point oysters' as the owner and its home address and will be easily identifiable by the orange bridles used to attach to the long lines.

**i. Marking**

- i. Our lease marking will be consistent with DMR regulations. During ice season December- March, our buoys will be removed

Two different systems will be used on the surface. During the first year a mix between the Oystergro cages and ADPI bags will be used. As more capital is generated, the ADPI bags will be phased out and the Oystergro cages will be the primary used surface grow out gear. On the most northern section of the suspended culture lease site there will be a mix use of suspended and bottom cages used. The Oystergro cages are industry standard as in they have 6 bag inserts. 10 long lines of 300' will hold 50 oyster cages each. 2 long lines of 100' will each hold 20 Oystergro cages, totaling a maximum capacity of 540 Oystergro cages. Oystergro cages will either be purchased at Ketchum Traps in New Bedford MA, or purchased used from a local oyster farm. We currently own 100+ ADPI bags and will not be purchasing any more of those. The moorings for the Oystergro cages will be 4' helix anchors purchased at Hamilton Marine. When a helix anchor cannot be used due to the substrate, a 150# cement block will be used in its place. On the 300' long lines, helix anchors will be used every 100 ft. Each helix anchor has a 6,500# break force ([www.westechrigging.com](http://www.westechrigging.com)). A local established oyster farm in the Damariscotta River will be helping us place our moorings for each long line to ensure proper and calculated measures are taken place.

The bottom cages measure 48"x36"x9" and are composed of 3/4" wire mesh and have no floatation devices. There is a wire mesh lid on top that lifts off and is held in place with bungee cord and clips. Each cage consists of top and bottom trays that are each 4.5" in depth (9 total). The two trays sit on top of each other. The bottom of the cages are held 6" off the seafloor by two wire mesh legs.

Bottom cages will be deployed in a straight line running generally north to south. Cages will be attached to a series of 100 ft. lines (3/8" sink rope) with each line strung between two 4' helix anchors. Where helix anchors can't be used due to a rocky substrate, a 150# cement block will be used. A total of 10 lines will be placed and each line will hold at maximum capacity 15 cages totaling 150 bottom cages. MLW at this area is 1-2ft and will be fully exposed on drainer tides.

Over wintering of the oysters will be either placed freely on the bottom or consolidated into Oystergro cages and lined up on the most southern region of the suspended aquaculture site.

### **3. OPERATIONS**

#### **a. Production Activities**

##### **i.**

- Boats on site Monday – Friday 6:00PM – 5:00PM
- One 21' Carolina skiff with a 115hp 4-stroke Honda outboard. Eventually will turn this into the drag boat
- One 16' Carolina skiff with a 40hp 2-stroke Tohatsu outboard
- Bottom culture of American oysters (*crassostrea virginica*), European (*ostrea edulis*) and northern quahog (*mercenaria mercenaria*)
- Harvesting will be done by a diver, wading, bull raking from a skiff, a small drag, and from floating cages. Suspended aquaculture is highlighted in the plan view. Floating cages will be used both for seed grow out and growing oysters out to maturity. Seed grow out bags will be placed at the beginning of July, whereas oystergro cages will be raised at the beginning of the season after being overwintered.
- Floating cages will be used for bringing oyster to market size. We have several LPA's further up the river that will be used for growing out oyster seed that will then be moved down here to the proposed lease site to be grown to market size. Floating cages will also be sunk in the winter with market sized oysters
- Harvesting will be performed daily depending on available stock and weather conditions

- A wash-down pump for cleaning oysters upon harvest will be used on the raft. An integrated muffler will be used on the wash-down pump for noise reduction
- Shellfish will be hand sorted on a nearby raft
- A shellfish raft approximately 12x16ft will be placed on a pre-existing 2,000lb mooring and also a 5' helix anchor within the proposed lease site to the south of Hog Island. This platform will be used for sorting and grading oysters and drying gear. It will also contain four 5x5x5 bins for wet storage. A framed structure 8x12x10ft with a temporary roof for shelter will be erected on the raft. This structure will eventually be enclosed to provide greater protection against the elements for workers.
- The owner of the company is also part owner of Hog Island and may use a work boat to go out to the island past daylight hours

ii.

- As this is an emerging aquaculture farm that to date has harvested less than 10,000 market oysters, the projected maximum production is to be determined. In 2018, between 250,000-500,000 oyster seed will be purchased and grown out at our current LPA's in the conditional growing zone north of rt. 1 bridge and then moved down to the proposed lease and either bottom planted or finished in floating cages. In 5 years' time we would like to be able to harvest 1 million oysters a year and assess from there.

iii.

- All grow out gear will purchased at Ketchum Traps in New Bedford MA, which is one of the industry leaders in selling aquaculture gear in New England

iv.

- At start up there will be 1 full time position created and 2 part time. At maximum production there will be 5 full time positions and 4 part time.

**b. Noise and Light**

- A shellfish raft approximately 12x16ft will be placed on a pre-existing 2,000lb mooring and also a 5' helix anchor within the proposed lease site to



the south of Hog Island. This platform will be used for sorting and grading oysters and drying gear. It will also contain four 5x5x5 bins for wet storage. A framed structure 8x12x10ft with a temporary roof for shelter will be erected on the raft. This structure will eventually be enclosed to provide greater protection against the elements for workers.

- A wash-down pump for cleaning oysters upon harvest will be used on the raft. An integrated muffler will be used on the wash-down pump for noise reduction. Wash-down pump will only be used during harvesting.
- Lights will not be used as all work will be done during daylight
- The owner of the company is also part owner of Hog Island and may use a work boat to go out to the island past daylight hours

**c. Upland Facilities or Holdings**

- Oysters will be brought back to either town boat launch or our slip at schooner landing and then brought to Damariscotta River Distribution at 68 main st. Newcastle, where oysters will be placed in a certified walk in cooler until sold for public consumption

**d. Current Operations**

- Currently we are operating out of 3 LPAs north of the rt. 1 bridge in the Damariscotta River.

#### **4. Environmental Characterizations**

a. The proposed lease is located to the east, south, and west of Hog Island and runs along the MLW mark of the island

- To the west of Hog Island is where the proposed suspended aquaculture will be located and is highlighted in yellow on the Plan view. The most northern part of this lease MLW mark is 1-2ft. This is where the bottom cages will be placed. No eel grass is reported here and is a medium hard mud.
- The bottom characteristics on the west side of the proposed lease is rock and ledge along the shore of the island and drops off to depths of 20-25ft MLW and is a mix of rock and shell hash. This is one of the deeper areas of the proposed lease and is where drag harvesting will take place. Softer mud is found on the northern west side of the lease where half of the proposed top culture is. Closer to goose ledge the site gets shallower and turns into a medium mud with shell hash.
- Approximate current speed varies with the tide but averages between 3-4 knots. The current direction travels N on the flood tide and S on the ebbing tide.

- To the south/south east of Hog Island there is a smaller 'channel' that runs 20-16ft deep at MLW. The bottom characteristics are also a mix of rock and shell hash. In this channel diving and dragging will be the means of harvesting.
- To the east of the most southern point of Hog island there is a small channel that runs along the beach towards west view acres rd. and gradually drops towards the most north western part of the proposed lease. Between the most north-western and south-western part of the lease is a soft/medium mud sight with light shell hash. This will only be dragged on an incoming tide as to make sure no suspended sediment travels to Dodge Cove Marine Farms lease sites positioned to the south.
- Along the MHW of the pebble beach on Hog island there is light patches of eel grass. Along the MLW oysters oysters will be planted and harvested via wading and hand harvesting. There is roughly a 75-100ft buffer between the two.
- Green crabs (*carcinus maenus*). horseshoe crabs ( *limulus Polyphemus*) and sand shrimp (*crangon septemspinosa*) are present in the proposed growing areas as well.

## 5. Area Resources

### a. Shellfish Beds, Fish Migration Routes and Submerged vegetation beds

- The proposed area abuts the eastern, southern and western boundaries of Hog island
- The proposed site is in the growing area 23A, an area classified as "open/approved for shellfish harvest"
- Alewives (*Alosa pseudoharengus*) are known to travel the river in early May and spawn in Damariscotta Lake
- Eelgrass (*Zostera marina*) has been spotted along the southern shores of hog island

### b. Essential Habitats/Endangered Species

- According to the Maine Department of Inland Fisheries and Wildlife (MDIF&W), data available through the Maine office of GIS, no endangered species are located near or the proposed lease.

## 6. Surrounding Area Use

### A. Riparian Property

1. Attached. The following data has been constructed from using NOAA terms of MLW and MHW. All riparian property owners within 1000' or to 1,650 feet from shore,



whichever is less, have been included. There are tidal flats north to Hall Point but those after careful and strategic calculations are not exposed at MLW but only are only exposed at MLLW (drainer tides) which is not to be included in the list per DMR regulations

2. Attached

3. Lease access will be from either public launch in Damariscotta or at Schooner Marina.

4. Attached. We have gained the appropriate approval from the owners of Hog Island, Parsons-Nelson LLC . Currently Parsons-Nelson LLC is using Hog Island as a seasonal summer house and is in full support of Black Stone Point Oysters LLC

**b. Existing Uses**

- Though where the top cultured cage system is proposed is not the main channel for navigation on the river, the occasional local boater will use that during high- mid tide. We have made sure to leave ample space for such navigation. The rest of the proposed lease will be strictly bottom culture of hand harvested along the shore at the appropriate tides.

- Recreational fishing will be permitted within the boundaries of the proposed lease

- The proposed Standard lease area will require that the applicant have exclusive use to the bottom area. Access will be limited to the applicant. All forms of commercial and recreational crab/lobster traps and commercial and recreational diving and dragging of any form will be restricted. Boating traffic will not be restricted in boundaries of the proposed lease.

## **7. Technical Capability**

Black Stone Point Oysters LLC officially formed in 2017, even though the owner Brendan Parsons has had two LPA's since 2016 and a third LPA in 2017. Brendan Parsons has been in the aquaculture business for past 10 years, first working at a farm in 2008, and operating raw bars at weddings in the summer through local caterers ever since. In 2015 he formed BP's Shuck Shack, Maine's first oyster food cart. In 2016 he purchased a second food cart. In 2017, he opened up Damariscotta River Distribution and River Bottom Raw Bar, both located in Newcastle, Maine.

## **8. Financial Capabilities**

a. Attached

b. **Cost estimates** – First year expenses

- Oyster seed - \$6,000
- Equipment - \$10,000
- Fuel - \$1,000
- Administrative - \$1,000
- Labor - \$5,000

**c. Other leases held by applicant**

- BPAR 117
- BPAR 217
- BPAR 316

**e. Other Leases and multiple ownerships continued.**

**A. Corporate Applicants**

1. Black Stone Point Oysters LLC. was incorporated in June of 2017 in the State of Maine. A copy of the Articles are attached

2. Brendan Parsons, Managing Member.  
236 Bayview rd.  
Nobleboro, Maine 04555

Stanley Tupper, Clerk

**Frederick, Quinlan & Tupper LLC.**

53 Exchange Street suite 400  
Portland, Maine 04101

3. Brendan Parsons is the sole owner and thus, the only director. His address is listed directly above under #2.

4. Brendan Parsons, the sole owner of Black Stone Point Oysters LLC has not applied for an aquaculture lease of Maine lands in the past besides the 3 LPA's he currently has

5. Brendan Parsons  
236 Bayview rd.  
Nobleboro, Maine 04555

100% Owner



6. . Brendan Parsons  
236 Bayview rd.  
Nobleboro, Maine 04555

100% interest in the following leases:

- BPAR 116
- BPAR216
- BPAR317

7. There have not been any State or Federal arrests, indictments, convictions of any marine resources or environmental protection laws by the officer/ director/ shareholder.

### **8. Other Requirements**

a. Per Maine DMR regulations chapter 2.40, Black Stone Point Oyster Co. will establish a performance bond upon lease approval.



1 A.

VICINITY MAP

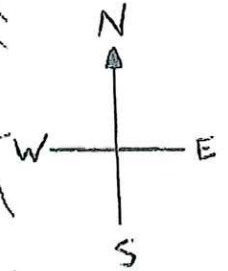
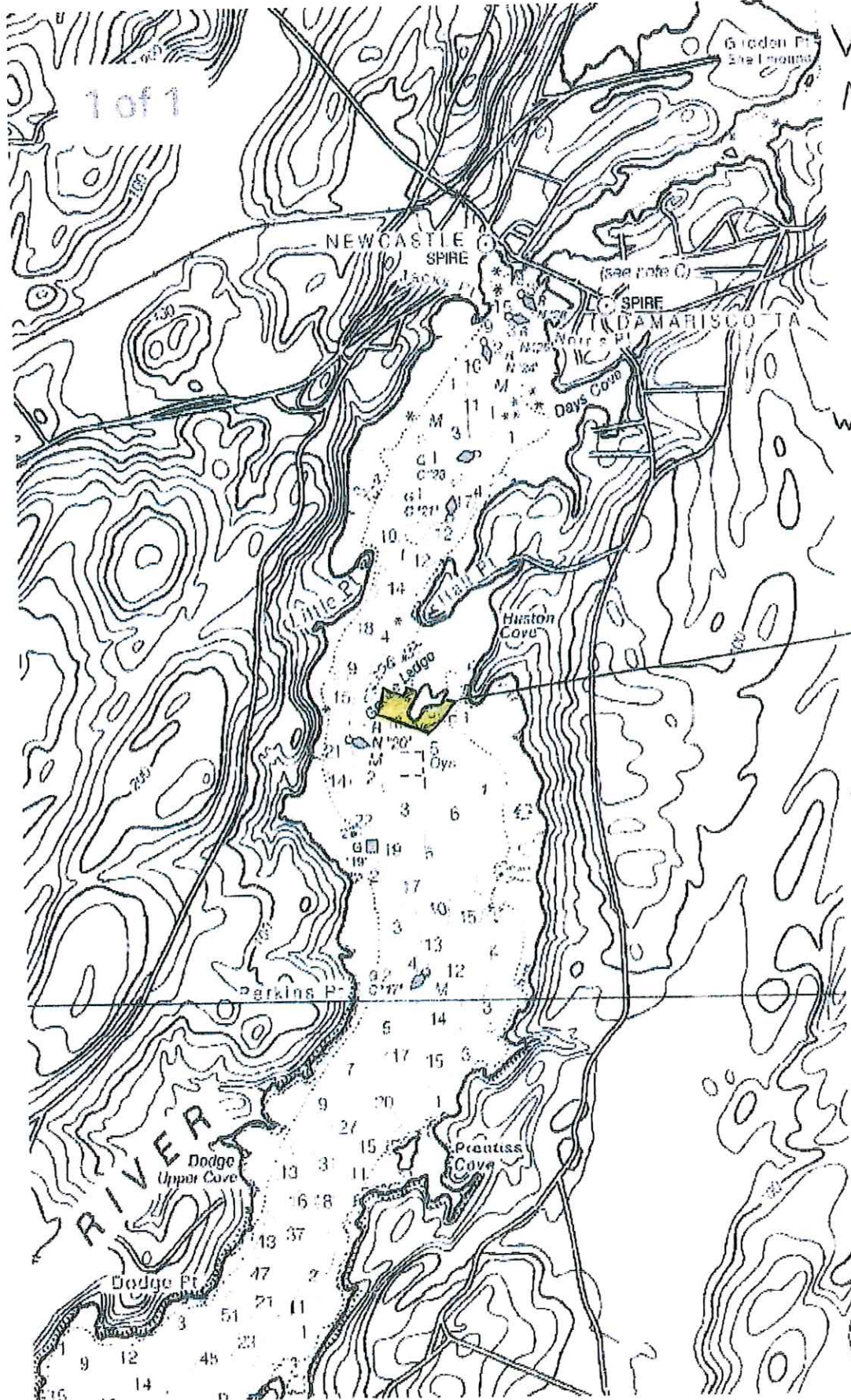

Proposed Lease site

Ebb ↓ Flow ↑

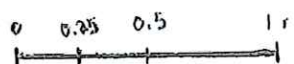



**Blackstone Point Proposed Standard Lease**  
 Write a description for your map. *B. Plan View*

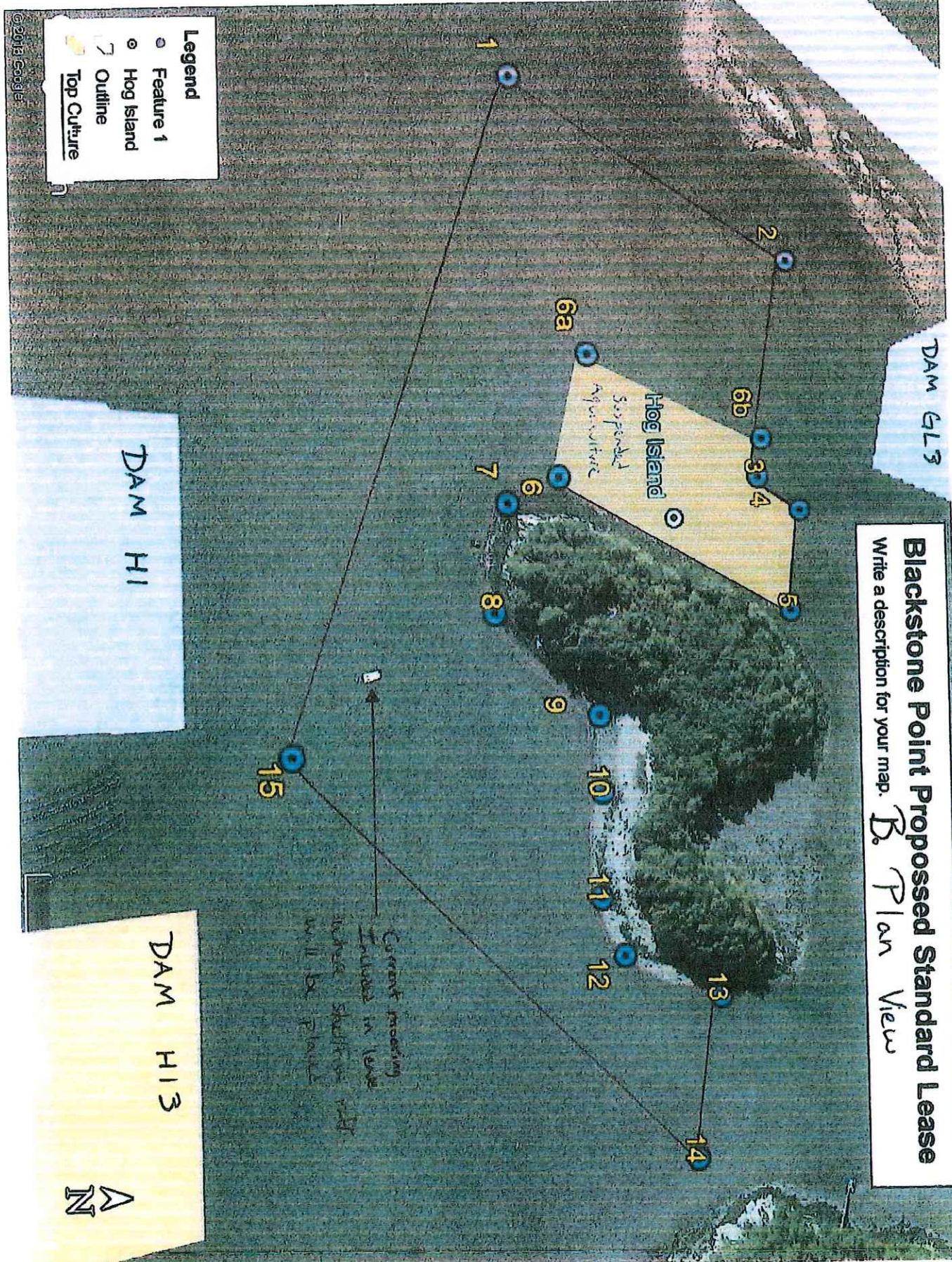



Blackstone Point Lease coordinates

Overall Lease – 12.98 acres

1. 44° 0'46.06"N 69°32'42.71"W
2. 44° 0'51.55"N 69°32'40.49"W
3. 44° 0'50.73"N 69°32'36.41"W
4. 44° 0'51.79"N 69°32'35.21"W
5. 44° 0'51.59"N 69°32'33.54"W
6. 44° 0'46.92"N 69°32'35.65"W
7. 44° 0'46.01"N 69°32'35.12"W
8. 44° 0'45.75"N 69°32'33.18"W
9. 44° 0'47.48"N 69°32'31.28"W
10. 44° 0'47.50"N 69°32'29.87"W
11. 44° 0'47.46"N 69°32'27.92"W
12. 44° 0'47.85"N 69°32'26.79"W
13. 44° 0'49.56"N 69°32'25.70"W
14. 44° 0'49.30"N 69°32'22.67"W
15. 44° 0'42.80"N 69°32'30.88"W

\* All datum was  
derived from Google Earth  
Pro, desktop version

Top Culture <sup>2.00</sup> ~~1.00~~ acres

3. 44° 0'50.73"N 69°32'36.41"W
4. 44° 0'51.79"N 69°32'35.21"W
5. 44° 0'51.59"N 69°32'33.54"W
6. 44° 0'46.92"N 69°32'35.65"W
- 6a. 44° 0'47.34"N 69°32'37.93"W
- 6b. 44° 0'50.80"N 69°32'36.67"W



# Suspended Gear - Single structure

Top view

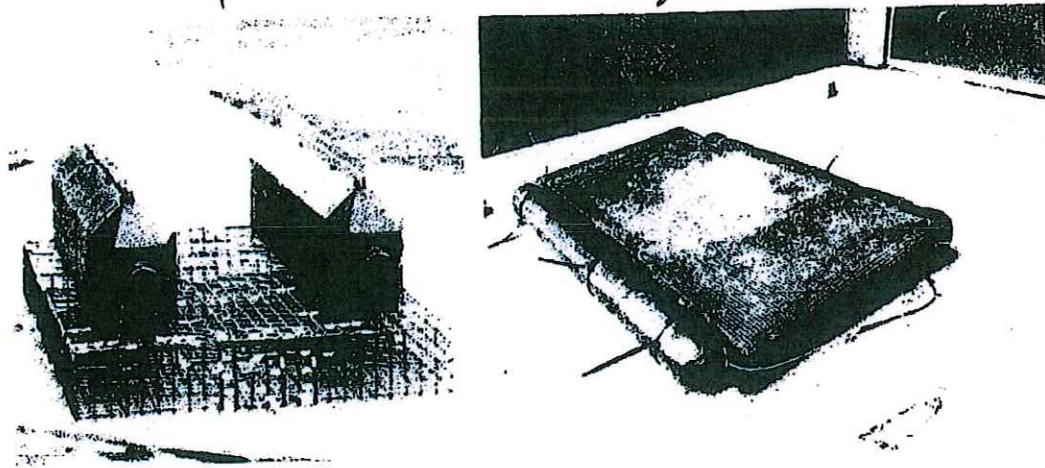

Left: a typical Oyster Gro style cage, shown out of the water. Cage is made of coated wire mesh, floats are black polyethylene, with end caps.

Right: a typical shellfish growing bag. Floats are attached to the sides to keep the bag at the surface, and a bridle/clip on each end is to attach the bag to the longline

## Cross Section

Oyster Gro

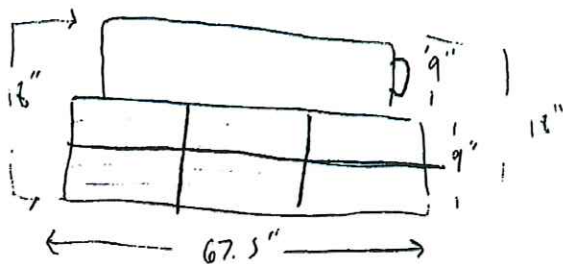
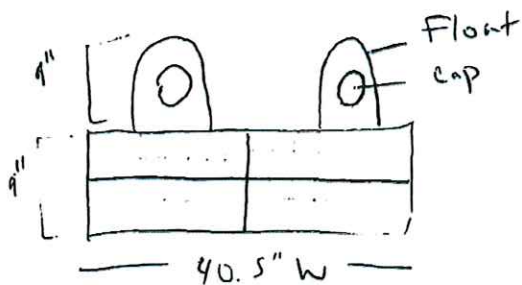

- Cage 9" T x 67.5" L x 40.5" W
- 8 @ 4.5" square marine grade wire mesh

79/14

ADP1 Shellfish Grow bags

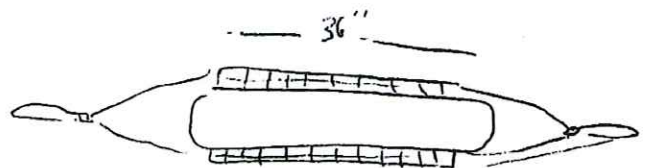
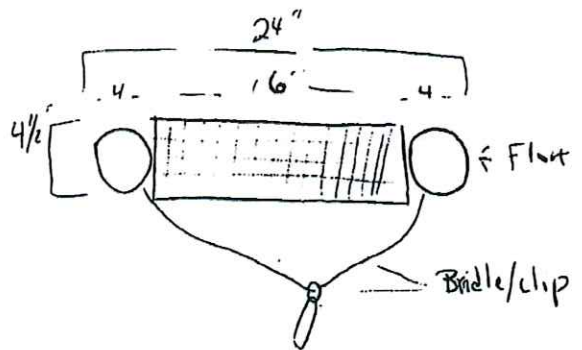

Float

Total Dimensions  
36" x 24" x 4 1/2" 3/8" square mesh

# Bottom Cages

Top view

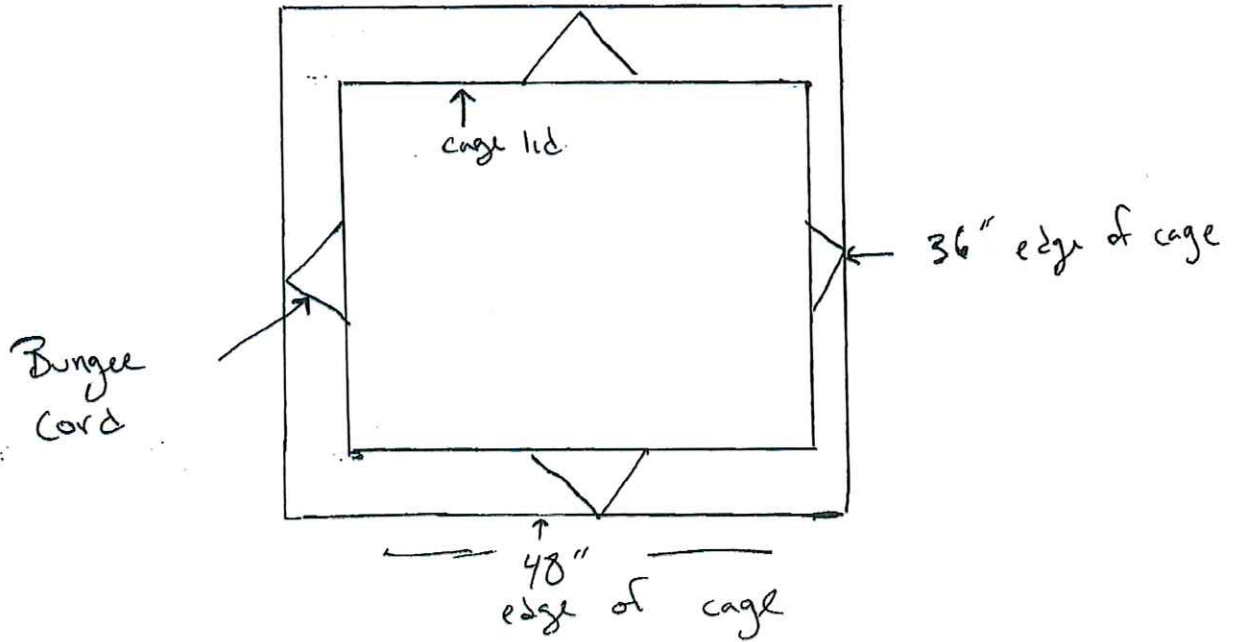

Cross section

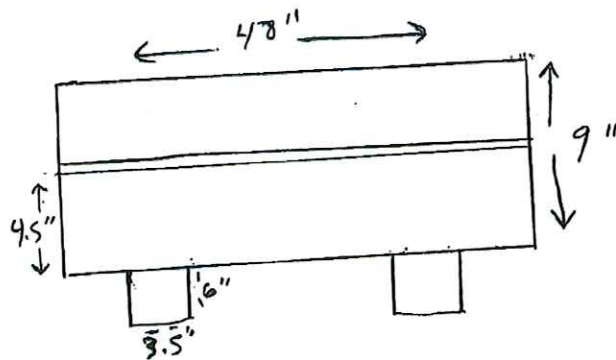

- Cages are 48" x 36" x 9"
- Made of 3/4" wire mesh
- Wire mesh lid on top, lifts off + held with bungee cord + clips

2 C.

# Suspended Culture Top View - Maximum structure

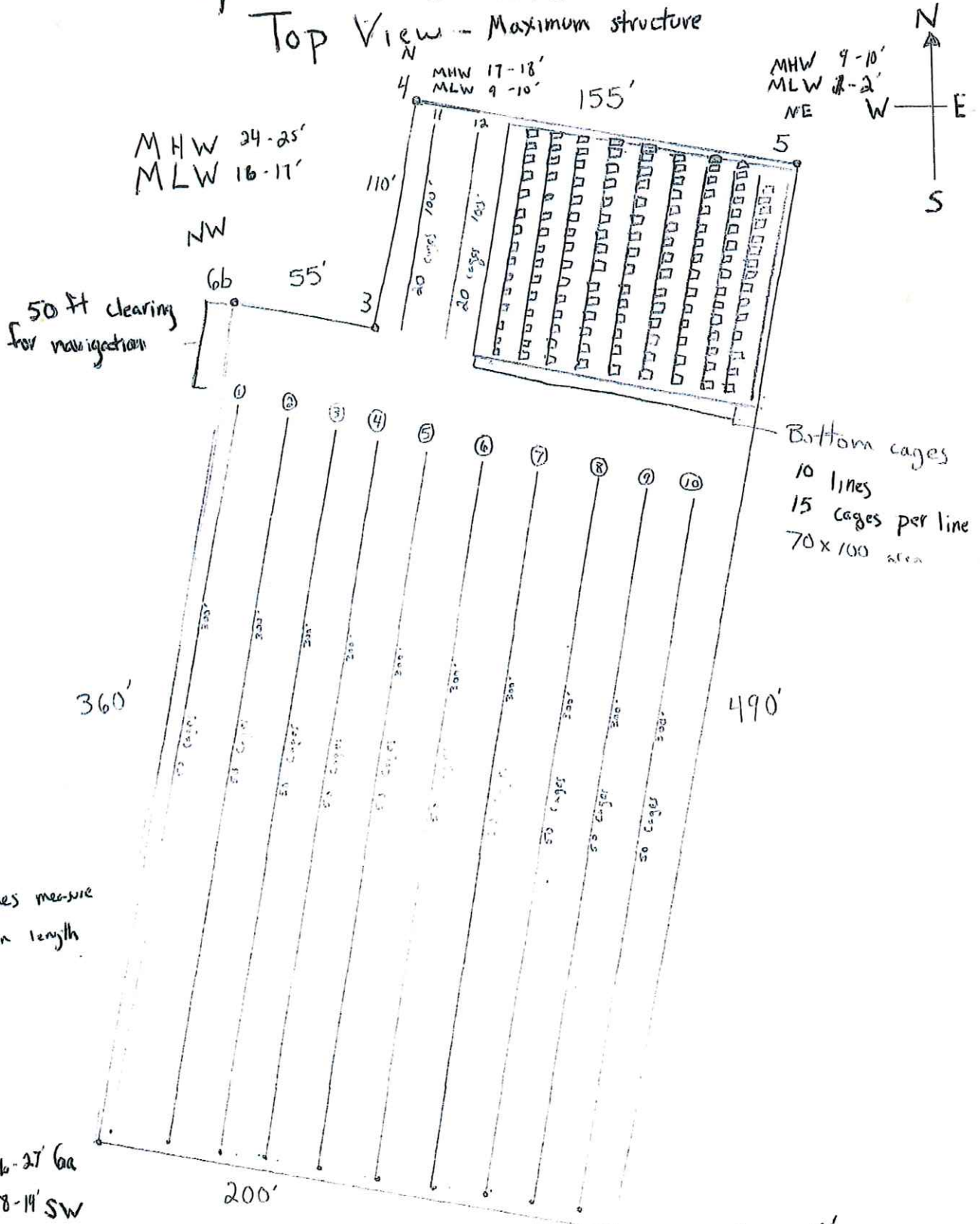



2.D

# SIDE VIEW - NORTH - SOUTH GEAR

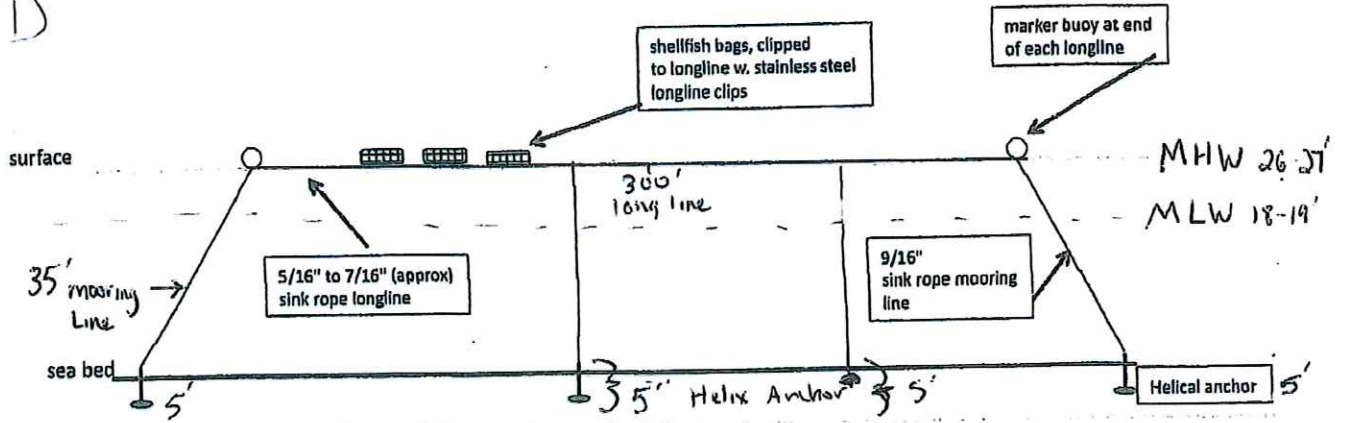

Bottom: Typical arrangement for winter for the lines that will have shellfish bags in summer. In winter, all surface gear is removed and only the line connecting the anchors remains. Shellfish are consolidated into OG cages, and sunk to the bottom.

surface

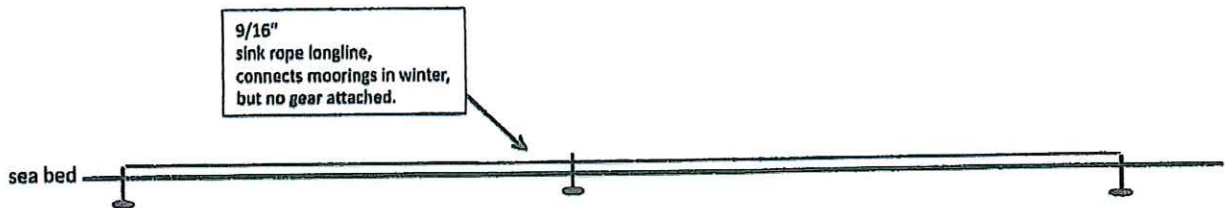

# 2 D. GROWING SEASON

Top: Typical line of Oyster Gro cages during growing season (not to scale). Helix anchors placed approx. every 50 feet along line; number of anchors per line will vary, per length of the longline.

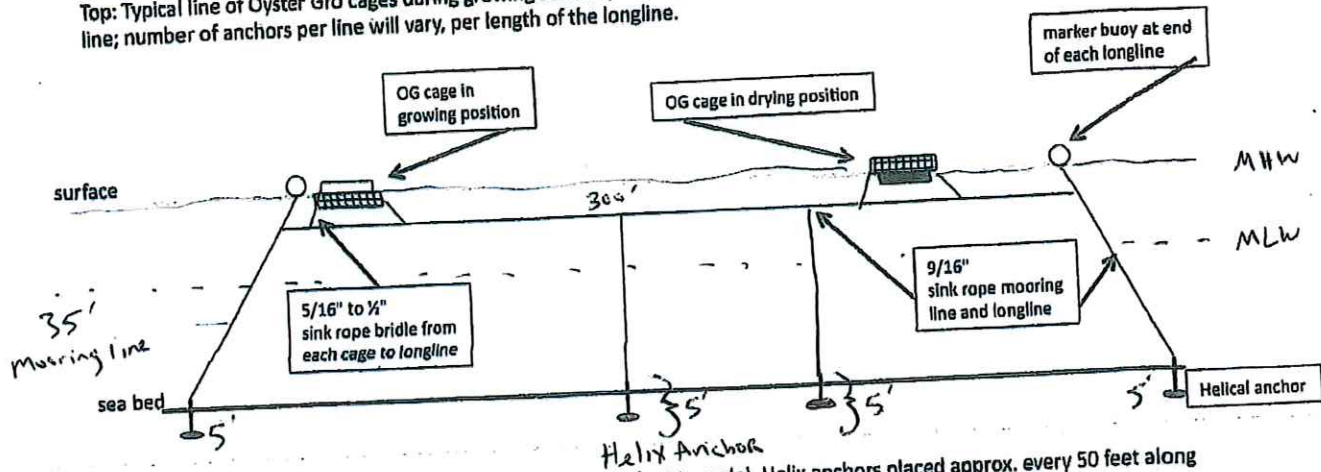

Bottom: Typical line of Oyster Gro cages during winter season (not to scale). Helix anchors placed approx. every 50 feet along line; number of anchors per line will vary, per length of the longline. Bridles to OG cages still connect to the longline, not shown in drawing. No surface floats remain during winter season. Depth varies along the site, described in application. OG cages are in the floats-down position during winter.

# OVER WINTERING

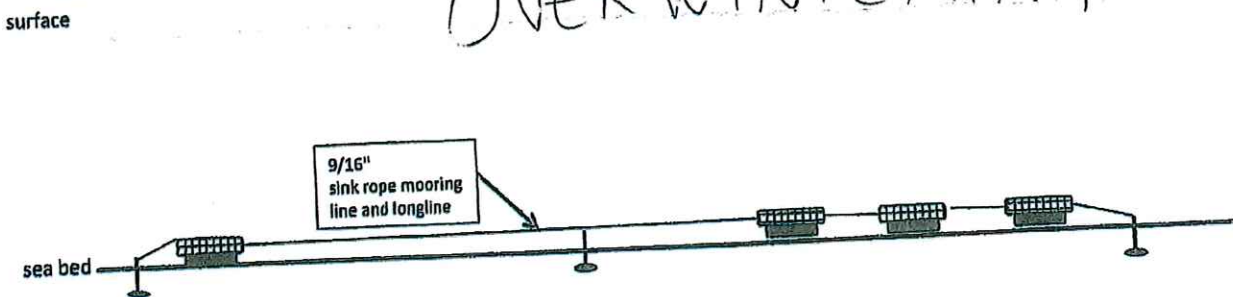

2. E

# Shellfish Raft

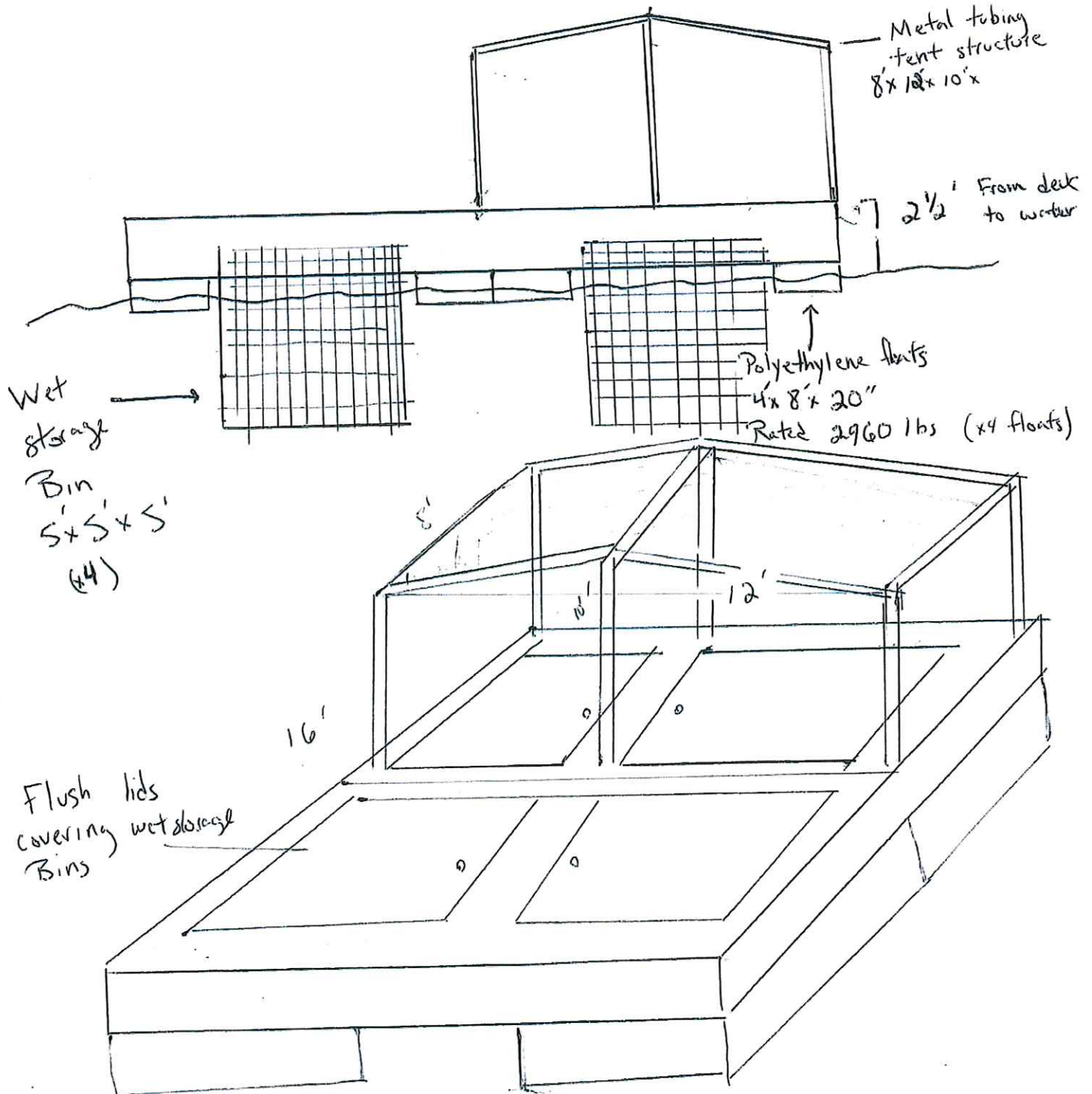



2. G

NORTHERN VIEW

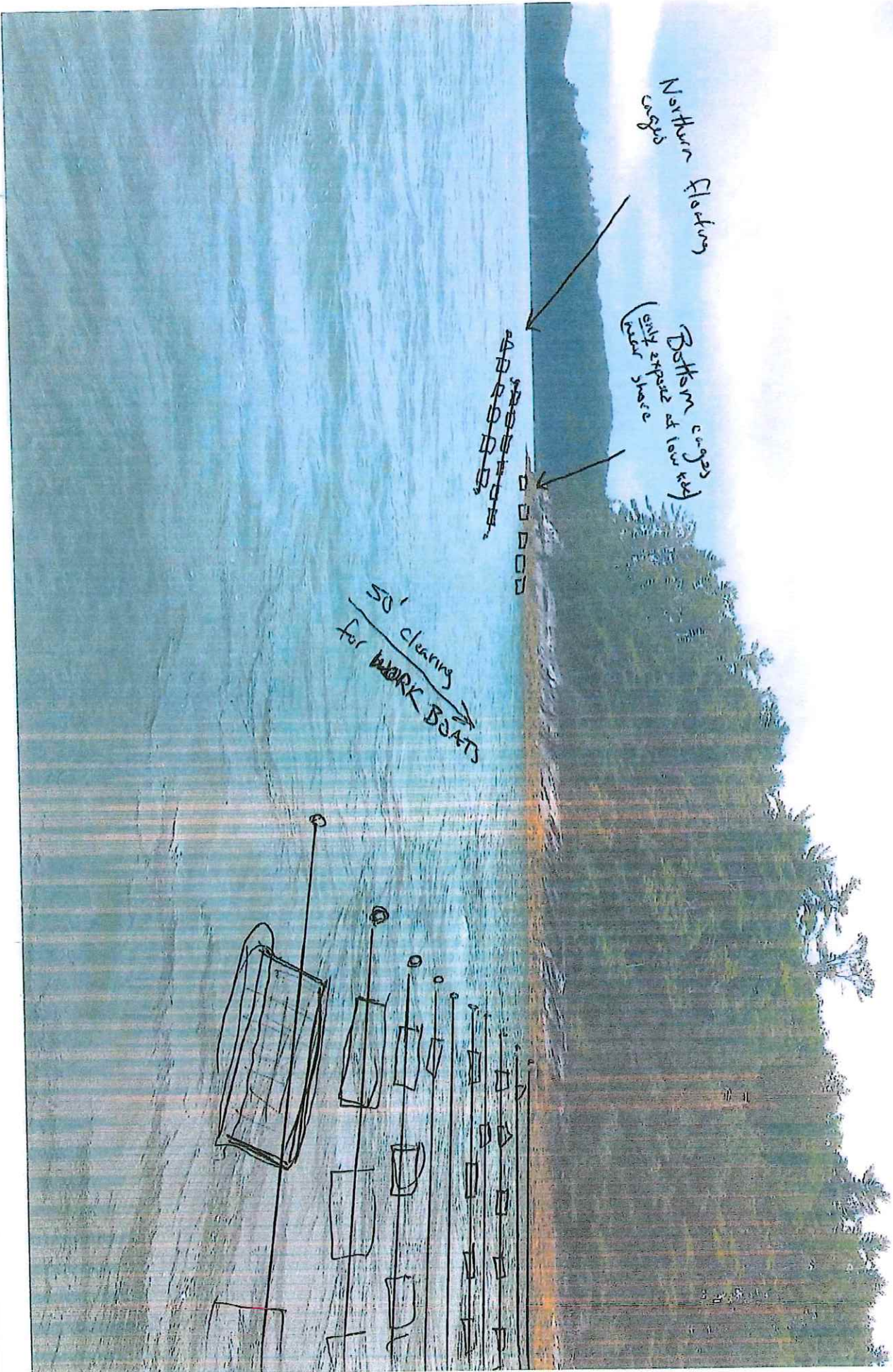



2.6

SOUTHERN VIEW





damariscottame.com

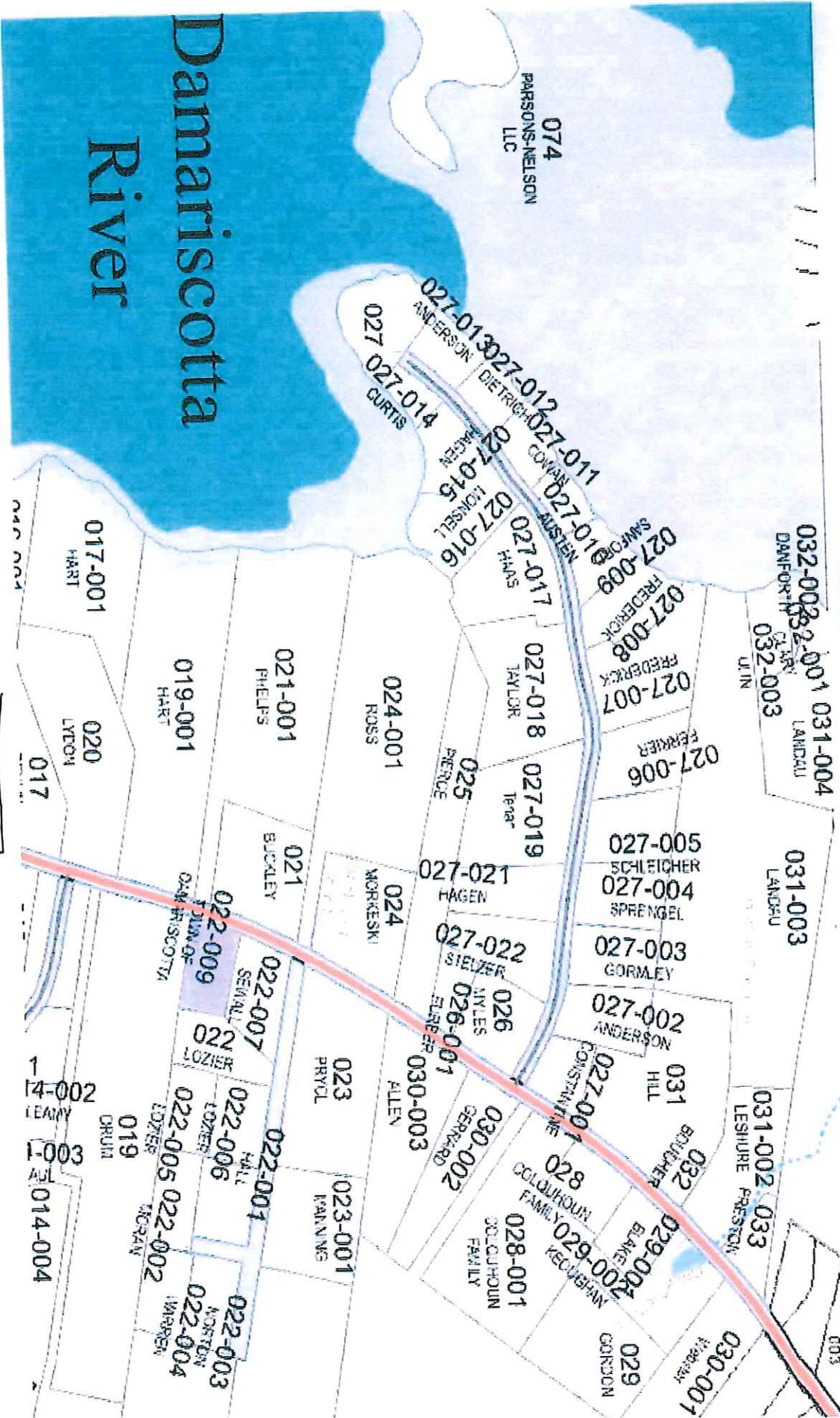

# Damariscotta River

Page 14

Page 22



U.S. Cellular 5:30 PM

0 500 1,000 ft



3D



33°

Search for a place or address

77.23



## MAINE DEPARTMENT OF MARINE RESOURCES

Limited Purpose Aquaculture License Program, P.O. Box 8, West Boothbay Harbor, ME, 04575 (207)-633-9531

### RIPARIAN OWNERS LIST For LPA applications

THIS LIST MUST BE  
\*\*\*CERTIFIED\*\*\*

On this list, please show the current owners' names and mailing addresses for all shorefront parcels within 300 feet of the proposed license site along with the map and lot number for each parcel. It is the applicant's responsibility to assemble the information for the Town Clerk to certify. The Town Clerk only certifies that the information is correct according to the Town's records. Once you have completed the form, ask the Town Clerk to complete the certification form below. If the parcels are within more than one municipality, provide a separate, certified, riparian list for each municipality.

TOWN OF: Damariscotta

MAP ##	LOT #	Landowner name(s) and address(es)
001	027-010	Austen, SC + KF + JA + KA + Ponne 34 Bradford road, Wellesley Hills, MA 02481
001	027-011	Cowan, Leah J.P. + John S. Ruckey 81 Westview rd Damariscotta ME 04543
001	027-012	Dietrich, Yvonne 91 Westview rd. Damariscotta ME 04543
001	027-013	Anderson, Thomas W. 265 Gerry Court, Walnut creek CA 94596
001	027-014	Curtis, Gertrude 98 Westview rd. Damariscotta ME 04543



MAP #	LOT #	Landowner name(s) and address(es)
001	027-015	Hagen, Lisa + Richard 88 Westview rd. Damariscotta ME 04543
001	027-016	Monsell, Ruth C. 82 Westview rd. Damariscotta ME 04543
001	027-017	Haas, Peggy T. PO Box 731 Damariscotta ME 04543
001	024-001	Ross, C. Edward + Sandra F PO Box 876 Damariscotta ME 04543
001	074	Parsons - Nelson LLC PO Box 762 Damariscotta ME 04543
001	021	Daniel Buckley 263 Bristol rd Damariscotta ME 04543
001	019	James Drum PO Box 847 Damariscotta ME 04543

**Please use additional sheets if necessary and attach hereto.**

**CERTIFICATION**

I, Rebecca Bartolotta, Deputy Town Clerk for the Town of Damariscotta, certify that the names and addresses of the property owners listed above, as well as the map and lot numbers, are those listed in the records of this municipality and are current as of this date.

SIGNED: R Bartolotta, Deputy DATE: 12/12/2018

SEAL:



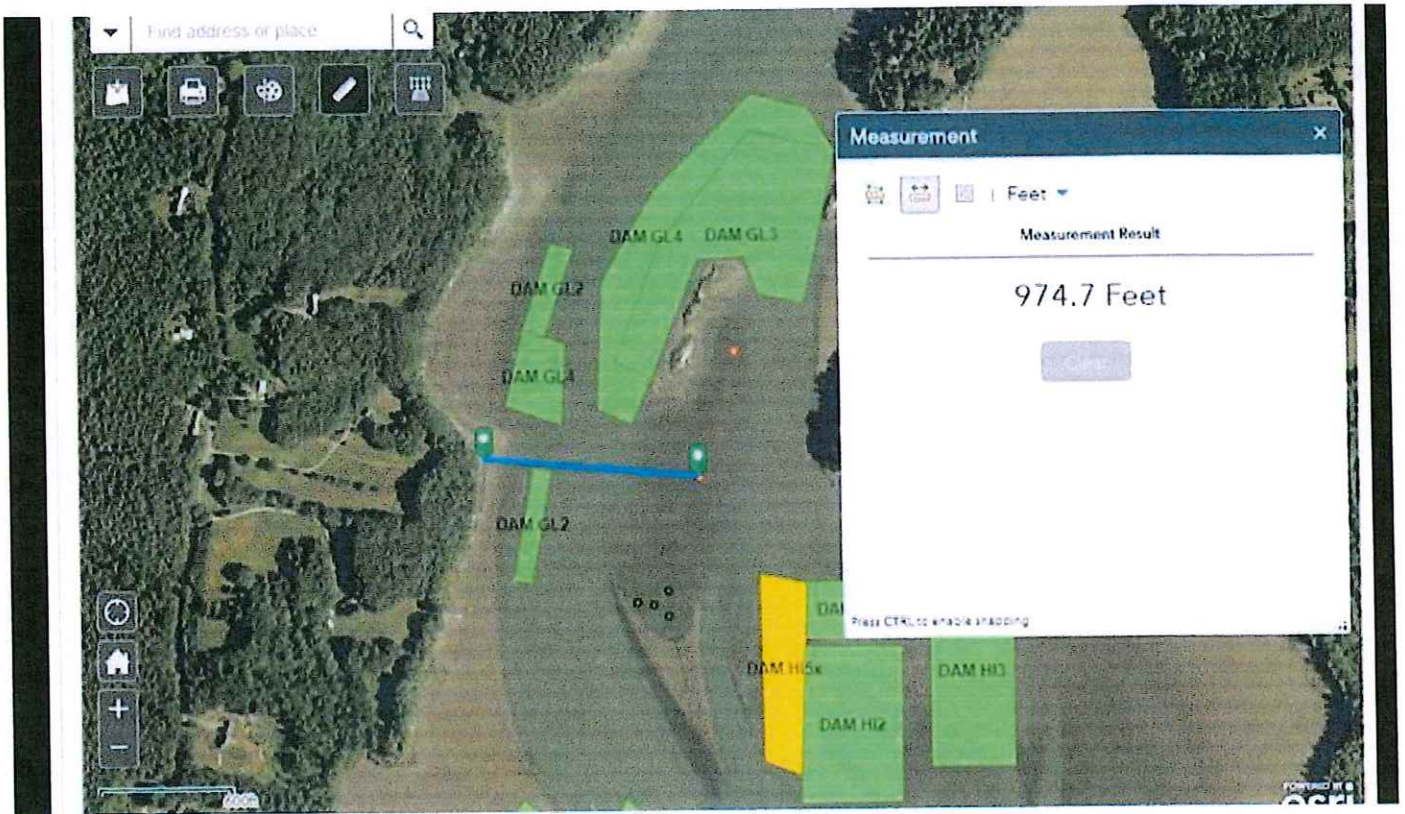

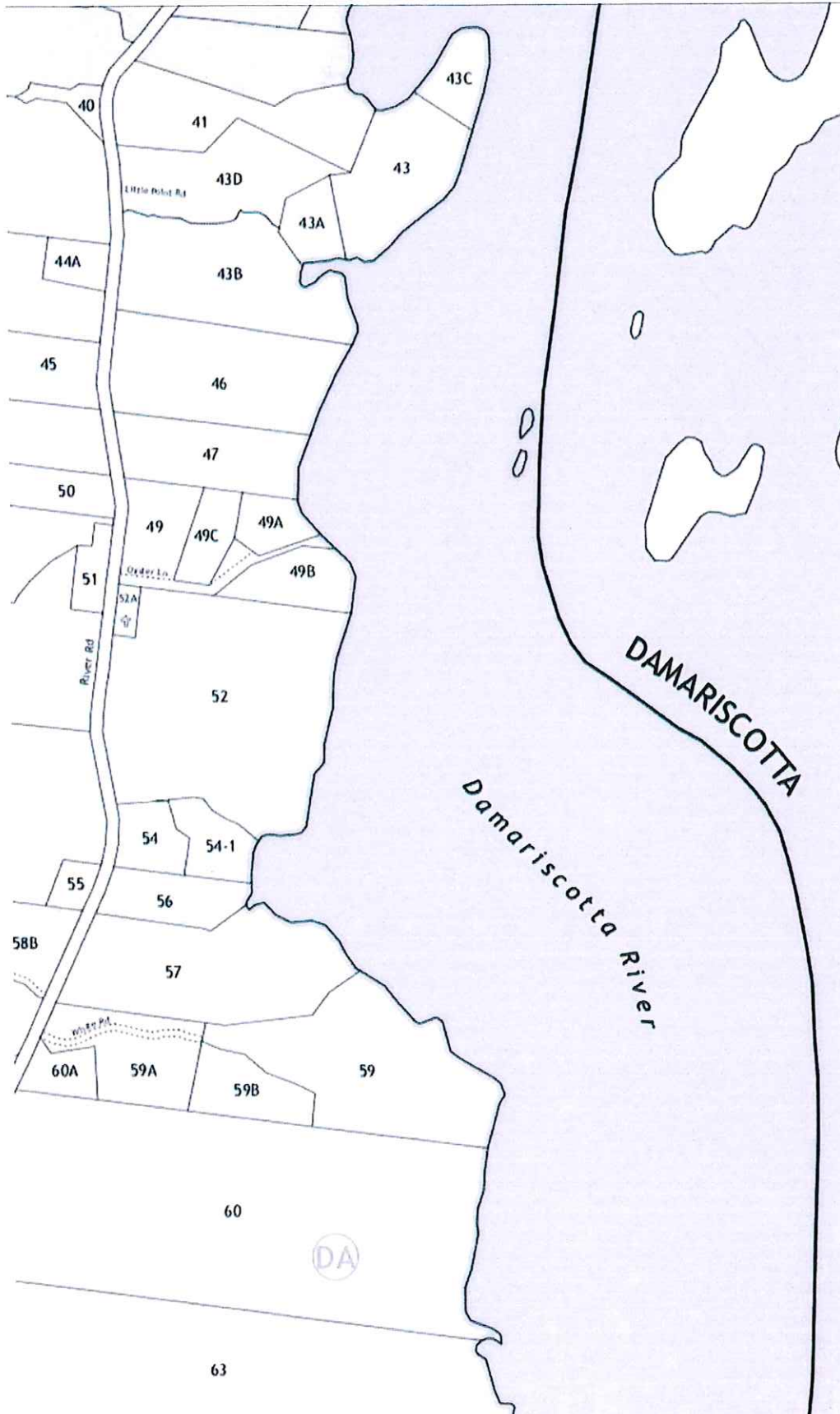

# RIPARIAN OWNERS LIST

For LPA applications

THIS LIST MUST BE

\*\*\***CERTIFIED**\*\*\*

On this list, please show the current owners' names and mailing addresses for all shorefront parcels within 300 feet of the proposed license site along with the map and lot number for each parcel. It is the applicant's responsibility to assemble the information for the Town Clerk to certify. The Town Clerk only certifies that the information is correct according to the Town's records. Once you have completed the form, ask the Town Clerk to complete the certification form below. If the parcels are within more than one municipality, provide a separate, certified, riparian list for each municipality.

TOWN OF: Newcastle

MAP ##	LOT #	Landowner name(s) and address(es)
003	049	Freeman, George M. + Brailovskaya, Tatiana 340 River rd. Newcastle ME 04553
003	049-B	Michael, Kathleen A. Michael, Dana 30 oyster Ln. Newcastle ME 04553
003	052	Ball, Cynthia B. Ball, Lancelot A. 5 Puritan rd. Wenham MA 01984



MAP #	LOT #	Landowner name(s) and address(es)

**Please use additional sheets if necessary and attach hereto.**

**CERTIFICATION**

I, Cheryl A Clifford <sup>Deputy</sup> Town Clerk for the Town of Newcastle, certify that the names and addresses of the property owners listed above, as well as the map and lot numbers, are those listed in the records of this municipality and are current as of this date.

SIGNED: Cheryl A Clifford DATE: 3-27-2019

**SEAL:**

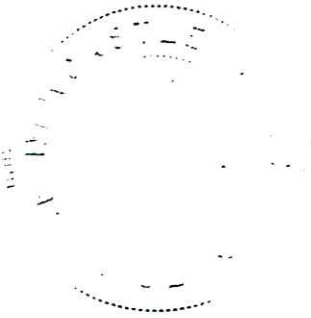

Friday, March 09, 2018

To Whom it May Concern,

Parsons-Nelson LLC is aware of all operations Black Stone Point Oysters LLC will be conducting around Hog Island. Parsons-Nelson LLC has given full permission for Black Stone Point Oysters LLC to operate on, and around its property, Hog Island on the Damariscotta River.

In the case that Brendan Parsons sells Black Stone Point Oysters LLC and is no longer the majority owner, then the access to Hog Island for Black Stone Point Oysters LLC operations would be relinquished.

For further questions please send all mail to PO BOX 762 Damariscotta ME, 04543

Sincerely,



Neil L. Parsons Jr, President of Parsons-Nelson LLC

Date:

3/9/18

MAINE  
LIMITED LIABILITY COMPANY  
  
STATE OF MAINE  
  
CERTIFICATE OF FORMATION

File No. 20175791DC Pages 2  
Fee Paid \$ 175  
DCN 2171911600096 DLLC  
FILED  
06/20/2017

*Julie R. Flynn*  
Deputy Secretary of State

A True Copy When Attested By Signature

Deputy Secretary of State

Pursuant to 31 M.R.S.A. §1531, the undersigned executes and delivers the following Certificate of Formation on:

**FIRST:** The name of the limited liability company is:

**Black Stone Point Oysters, LLC**

(A limited liability company name must contain the words "limited liability company" or "limited company" or the abbreviation "L.L.C.", "LLC", "L.C." or "LLC", or, in the case of a low-profit limited liability company, "L3C" or "L3C" - see 31 M.R.S.A. § 98.)

**SECOND:** Filing Date: (select one)

Date of this filing; or

Later effective date (specified here): \_\_\_\_\_

**THIRD:** Designation as a low profit LLC. (Check only if applicable):

This is a low-profit limited liability company pursuant to 31 M.R.S.A. §1611 meeting all qualifications set forth here:

- A. The company intends to qualify as a low-profit limited liability company;
- B. The company must at all times significantly further the accomplishment of one or more of the charitable or educational purposes within the meaning of Section 170(c)(2)(B) of the Internal Revenue Code of 1986, as it may be amended, revised or succeeded, and must list the specific charitable or educational purposes the company will further;
- C. No significant purpose of the company is the production of income or the appreciation of property. The fact that a person produces significant income or capital appreciation is not, in the absence of other factors, conclusive evidence of a significant purpose involving the production of income or the appreciation of property; and
- D. No purpose of the company is to accomplish one or more political or legislative purpose within the meaning of Section 170(c)(2)(D) of the Internal Revenue Code of 1986, or its successor.

**FOURTH:** Designation as a professional LLC. (Check only if applicable):

This is a professional limited liability company\* formed pursuant to 13 M.R.S.A. Chapter 22-A to provide the following professional services:

(Type of professional services)

Form No. MLLC-6 (1 of 2)



FIFTH: The Registered Agent is a. (select either a Commercial or Noncommercial Registered Agent)

Commercial Registered Agent CRA Public Number: \_\_\_\_\_

\_\_\_\_\_  
(Name of commercial registered agent)

Noncommercial Registered Agent

**Brendan R. Parsons**

\_\_\_\_\_  
(Name of noncommercial registered agent)

**236 Bayview Road, Nobleboro, ME 04555**

\_\_\_\_\_  
(physical location, not P.O. Box - street, city, state and zip code)

**N/A**

\_\_\_\_\_  
(mailing address if different from above)

SIXTH: Pursuant to 5 MRSA §105.2, the registered agent listed above has consented to serve as the registered agent for this limited liability company.

SEVENTH: Other matters the members determine to include are set forth in the attached Exhibit \_\_\_\_\_, and made a part hereof.

\*\*Authorized person(s)

Dated 6-12-17

  
\_\_\_\_\_  
(Signature of authorized person)

**Stanley Tupper, Esq.**  
\_\_\_\_\_  
(Type or print name of authorized person)

\_\_\_\_\_  
(Signature of authorized person)

\_\_\_\_\_  
(Type or print name of authorized person)

\*Examples of professional service limited liability companies are accountants, attorneys, chiropractors, dentists, registered nurses and veterinarians. (This is not an inclusive list - see 13 MRSA §723.7)

\*\*Pursuant to 31 MRSA §1676.1.A, Certificate of Formation MLST be signed by at least one authorized person.

The execution of this certificate constitutes an oath or affirmation under the penalties of false swearing under 17-A MRSA §453.

Please remit your payment made payable to the Maine Secretary of State.

Submit completed form to: Secretary of State  
Division of Corporations, LLC and Commissions  
101 State House Station  
Augusta, ME 04333-0101  
Telephone Inquiries: (207) 624-7752 Email Inquiries: C&C.Corporations@Maine.gov

Form No. MLLC-6 (2 of 2) Rev 10/31/2012